

Online Faculty Update

From the Center for Instructional Technology

Winter 2011

Newsletter

WSU Virtual Class Held In Second Life. Lynn Zayac, Director CIT



Dr. Larry Griffith held WSU's first virtual class on the WSU Island in Second Life this fall. This fall there was a class held in Second Life and Moodle (Sloodle). Dr. Larry Griffith held his Operating Systems class in this environment and will be sharing his experience with teaching in Sloodle in the spring. We will notify you with details of this presentation once it has been scheduled.

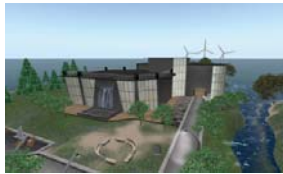

WSU's official island in Second Life contains a conference center with media screens to host events or classes up to 100 avatars at one time. The CIT department has held trainings for WSU faculty and staff to learn how to get to the Westfield Island in Second Life, and use the system to communicate and teach in a virtual world. You can go to www.secondlife.com to find out more about this exciting virtual world.

Winter Plato Course Request Deadline - December 17th!



All instructors using Plato for their Winter 2011 courses must request Plato shells no later than December 17th to ensure correct loading of students into the system (The Spring Deadline is January 10th). In order to load students into Plato courses on the first day of classes, all courses must be created before the deadline. Requesting courses after the start of classes creates problems and conflicts in loading students into courses correctly. Go to www.wsc.ma.edu/plato and click on the **Faculty News and Resources** link to find the form and several tutorials on how to use the form. If you have questions regarding this deadline contact Salim at sibrahim@wsc.ma.edu or call 413-572-5664.

REMINDER: "Flip the switch" in MyWestfield!

If you are using Plato it's time to "Flip the Switch" - Each semester If you are using Plato for your course content, you must go into MyWestfield and "flip the switch" to push students through to the Plato system. This is not an automatic process and if not done, students logging in through MyWestfield will be stuck in an empty course shell. It is VERY easy. Here are the steps. 1. Log in to MyWestfield. 2. Click on the faculty tab. 3. Click on "Click here to view my courses". 4. Click the little pencil next to each course. 5. Choose the Plato option. 6. Click SAVE CHANGES. 7. Follow steps 4 - 6 for the rest of your courses. Please email Lisa at lclark@wsc.ma.edu if you have questions. Thank you.



For more information contact:
Lisa Clark, Online Faculty Support Specialist
413-572-8249 lclark@wsc.ma.edu
www.wsc.ma.edu/plato



It's time for a Plato course tune-up!

Schedule a meeting with Lisa to tune-up your online or face to face enhanced course for the Spring semester. Learn easy ways to streamline communications, and make it clear what you want your students to be doing. Discuss a PowerPoint, or show how to do a problem in Excel with easy, free screen capture software from TechSmith. Learn how to set up a virtual office (Vroom, by Elluminate) to meet with students in real time, online from just about anywhere. Whether you want to add an image to your course, or meet with your students online, Lisa can get you up to speed in no time.



ALSO! IMPORTANT EPACK REMINDER! If you are using an Epack or Course Cartridge in your Plato course this semester, please verify with your Publisher that your students will have the **correct access code and book** to go with the epack that you have loaded into your Plato course. Especially if you are copying content from a previous semester.

Clicker Update from Joe Axenroth



TurningPoint

During the course of the semester using TurningPoint, the need or want may arise to keep track of student responses using the reporting tool. Although TurningPoint's reporting feature is a very powerful tool, Turning Technologies recently deployed an application called ResultsManager that allows you to work on reports across multiple sessions seamlessly and easily. On Thursday, January 6th, 2011 from 2-3 PM, Turning Technologies is hosting a FREE webinar on the technological and pedagogical best practices for both TurningPoint Any-Where and ResultsManager. Contact Joe Axenroth at x8130 or jaxenroth@wsc.ma.edu for more information. You can also view the 'TurningPoint @ CIT' blog at tpcit.blogspot.com for more ideas. ~ Joe

Smarthinking - Free Online Tutoring



SMARTHINKING is a FREE online tutoring for a variety of subjects available to students attending Westfield (WSU). SMARTHINKING's fundamental objectives are to engage and encourage students in active learning, as well as to enhance their motivation. Our tutors strive to help students develop successful learning skills, rather than simply "giving answers" or "doing homework" for them. In a professional and supportive environment, we focus on the power of human interaction and the use of technology to assist a student-centered tutoring process. Go to www.wsc.ma.edu/plato to find the login button. Students use their WSU email address to create their accounts.

Web 2.0 Trainings

Schedule a one on one or department training to learn more about the wonderful world of Web 2.0. Learn how to use great applications, such as Facebook, Twitter, Diigo, Google Apps, RSS Feeds and many more exciting new tools. Please contact Lisa at lclark@wsc.ma.edu for more information.



Important Web Links

- Onsite Student Support:** jaxenroth@wsc.ma.edu
- 24/7 Plato Student Support:** platohelp.wsc.ma.edu/
- Online Tutoring:** cit.wsc.ma.edu/smarthinking/
- Faculty Plato Support:** lclark@wsc.ma.edu
- After Hours Faculty Plato Support:** cit.wsc.ma.edu/helpdesk

Faculty News & Resources: you can find more Plato resources on the Faculty News & Resources link on the right side of the Plato page at www.wsc.ma.edu